

**Vertical 1xMCCB kit X160, quadro evo, 800x200 mm**

**Technical properties**

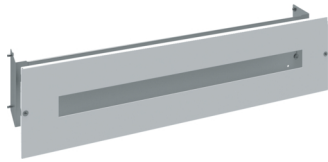

UC182XD

**Configuration**

Number of modules	0
-------------------	---

**Dimensions**

Depth of installed product	188 mm
Height of installed product	200 mm
Width of installed product	800 mm

**Capacity**

Quantity of half modules terminales per rail	0
--	---

**Cover, door**

Cover type	Cover
------------	-------

**Materials**

RAL colour	RAL 9010 - Pure white
------------	-----------------------

**Installation, mounting**

Quantity of terminal steps in 1/2 modules on kit	0
--	---

**Scope of delivery**

With cover	Yes
------------	-----

**Equipment**

Number of units	1
Number of rows	0
Quantity of rails	0
Can be accessorized	Yes
Quantity of steps in height	4

**Standards**

Approvals	EN 61439-1/-2
European directive WEEE	not concerned

**Safety**

Protection class	isol.class I
REACH conform	No
RoHS conform	Yes
Halogen free	Yes