

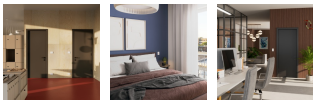

WBM10RUD



## Mechanism 10A rotary UP DOWN

### Technical properties

#### Voltage

Nominal voltage 250 - 250 V

#### Installation, mounting

Mounting on Flush mounting

#### Safety

Ingress Protection (IP) class IP20

#### Dimensions

Depth 45 mm

#### Materials

Colour White

#### Architecture

Control/operation element Rotative

#### Texts

Type of connection With screw terminals